

EIAJ RC5320A TYPE4

電圧区分4

適合品

RATING 定格 : DC13.5V 2A

No. MP-204

5.5×3.3 (center pin : 1.0) DC PLUG
EIAJ RC5320A TYPE4 電圧区分4
(DC 10.5V ~ 13.5V 2A)

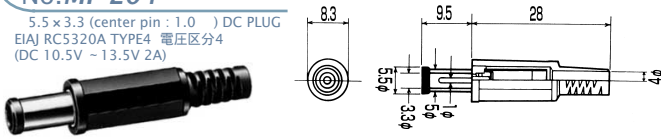

No. MP-204LN

5.5×3.3 (center pin : 1.0) RIGHT ANGLE DC PLUG
EIAJ RC5320A TYPE4 電圧区分4
(DC 10.5V ~ 13.5V 2A)

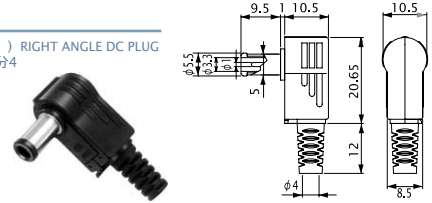

No. MC-5324

DC ADAPTOR CABLE L=1800mm
5.5×3.3 (center pin : 1.0) DC PLUG
EIAJ RC5320A TYPE4 電圧区分4
(DC 10.5V ~ 13.5V 2A)



No. MC-5324L

RIGHT ANGLE DC ADAPTOR CABLE L=1800mm
5.5×3.3 (center pin : 1.0) DC PLUG
EIAJ RC5320A TYPE4 電圧区分4
(DC 10.5V ~ 13.5V 2A)



No. M04-700A0

No. M04-700D1

DC JACK FOR P.C.B.
PLUG TYPE: 5.5×3.3 (center pin : 1.0)
EIAJ RC5320A TYPE4 電圧区分4
(DC 10.5V ~ 13.5V 2A)

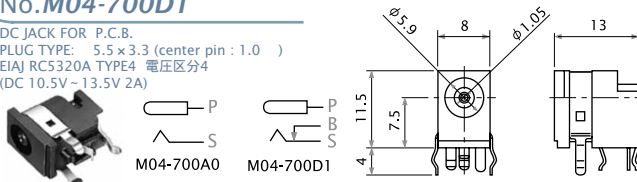

No. MJ-084N

DC INLINE JACK
PLUG TYPE: 5.5×3.3 (Center pin : 1.0)
EIAJ RC5320A TYPE4 電圧区分4
(DC10.5V ~ 13.5V 2A)

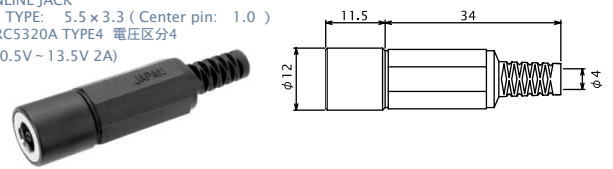

No. M04-480DJ

DC JACK FOR P.C.B.
PLUG TYPE: 5.5×3.3 (center pin : 1.0)
EIAJ RC5320A TYPE4 電圧区分4
(DC 10.5V ~ 13.5V 2A)

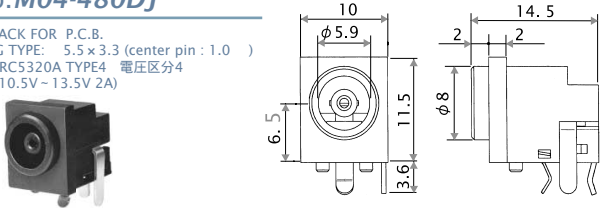

No. M04-390DJ

DC JACK FOR P.C.B.
PLUG TYPE: 5.5×3.3 (center pin : 1.0)
EIAJ RC5320A TYPE4 電圧区分4
(DC 10.5V ~ 13.5V 2A)

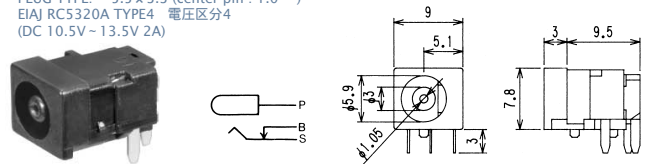

No. MJ-19A

PANEL MOUNT DC JACK
PLUG TYPE: 5.5×3.3 (center pin : 1.0)
EIAJ RC5320A TYPE4 電圧区分4
(DC 10.5V ~ 13.5V 2A)

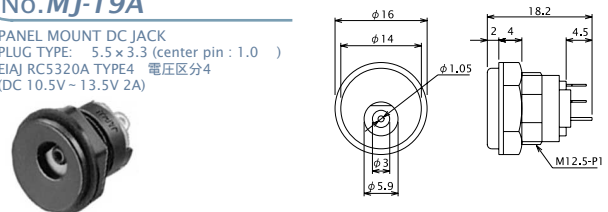

Marushin electric mfg. co., ltd.