



AUDIO PHONE PLUGS & JACKS

2-CONDUCTOR SUB-MINIATURE PLUGS

2.5 - 2極超小形単頭プラグ

No.MP-101MH (2.5 -2極)

MONO SCREW PART: PLASTICS

No.MP-101A (2.5 -2極)

MONO SCREW PART: METAL

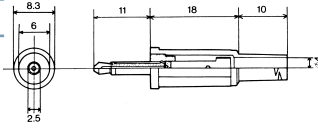

No.MP-101ML (2.5 -2極)

MONO SCREW PART: PLASTICS

No.MP-101MLA

MONO SCREW PART: METAL

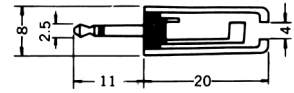

No.MP-101MR (2.5 -2極)

SCREW PART: PLASTICS
MONO



No.MP-101C (2.5 -2極)

MONO w/shielded handle

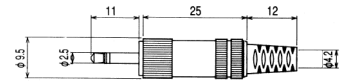

No.MC-25MN (2.5 -2極)

SUB-MINIATURE PLUG WITH 1.8M LONG CABLE
2-CONDUCTOR



No.MP-022LN (2.5 -2極)

MONO

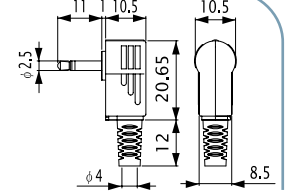

No.MC-25MNL (2.5 -2極)

SUB-MINIATURE RIGHT ANGLE PLUG WITH 1.8M LONG CABLE
2-CONDUCTOR



2-CONDUCTOR SUB-MINIATURE JACKS

2.5 - 2極超小形単頭ジャック

No.MJ-165N (2.5 -2極)

SUB-MINIATURE INLINE JACK
MONO

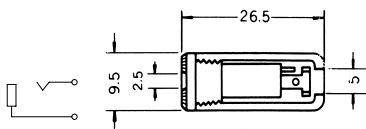

No.MJ-165AN (2.5 -2極)

SUB-MINIATURE INLINE JACK
MONO

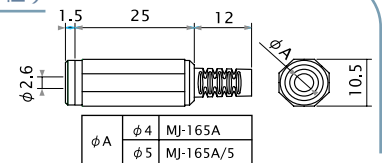

No.MJ-0252S (2.5 -2極)

2-CONDUCTOR SUB-MINIATURE INLINE JACK
MONO

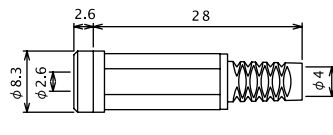

No.MJ-2625 (2.5 -2極)

2-CONDUCTOR SUB-MINIATURE JACK FOR P.C.B
MONO

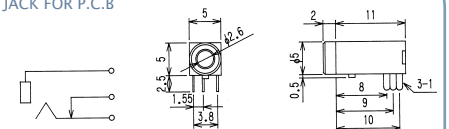

Marushin electric mfg. co., ltd

2-CONDUCTOR SUB-MINIATURE JACKS

2.5 - 2極超小形単頭ジャック

No.MJ-165H (2.5 -2極)

PANEL MOUNT SUB-MINIATURE JACK
MONO

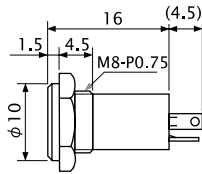

No.MJ-165SP (2.5 -2極)

SNAP-IN MOUNT SUB-MINIATURE JACK
MONO

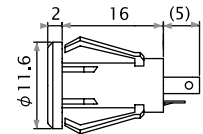

No.MJ-255 (2.5 -2極)

PANEL MOUNT SUB-MINIATURE JACK
MONO

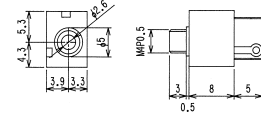

3-CONDUCTOR SUB-MINIATURE PLUGS

2.5 - 3極超小形単頭プラグ

No.MP-026L (2.5 -3極)

3-CONDUCTOR SUB-MINIATURE PLUG
w/shielded handle
STEREO

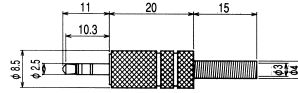

No.MP-025MH (2.5 -3極)

3-CONDUCTOR SUB-MINIATURE PLUG
STEREO

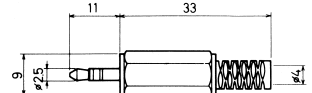

No.MC-25STL (2.5 -3極)

SUB-MINIATURE RIGHT ANGLE PLUG WITH 1.8M LONG CABLE
3-CONDUCTOR



No.MP-023LN (2.5 -3極)

3-CONDUCTOR SUB-MINIATURE RIGHT ANGLE PLUG
STEREO

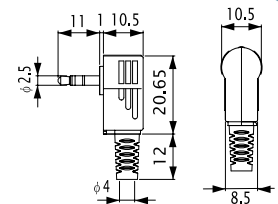

3-CONDUCTOR SUB-MINIATURE JACKS

No.MC-25ST (2.5 -3極)

SUB-MINIATURE PLUG WITH 1.8M LONG CABLE
3-CONDUCTOR



No.MJ-072 (2.5 -3極)

SUB-MINIATURE INLINE JACK
STEREO

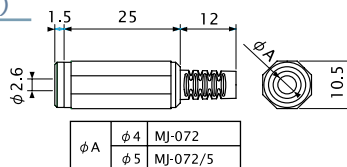

2.5 - 3極超小形単頭ジャック

No.MJ-0253S (2.5 -3極)

3-CONDUCTOR SUB-MINIATURE INLINE JACK
STEREO

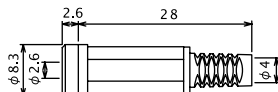

No.MJ-071 (2.5 -3極)

SUB-MINIATURE INLINE JACK
STEREO

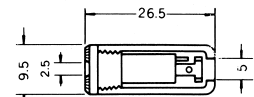

No.MJ-3625 (2.5 -3極)

3-CONDUCTOR SUB-MINIATURE JACK FOR P.C.B
STEREO

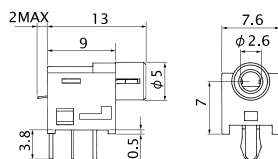

No.MJ-2-348A0 (2.5 -3極) With Metal Sleeve

No.MJ-2-348B0 (2.5 -3極) Without Metal Sleeve

3-CONDUCTOR SUB-MINIATURE JACK FOR P.C.B
STEREO

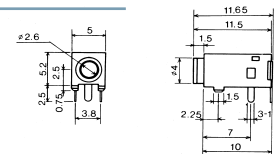

No.MJ-A18 (2.5 -3極)

3-CONDUCTOR SUB-MINIATURE JACK FOR P.C.B
STEREO

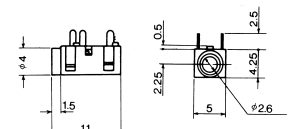



AUDIO PHONE PLUGS & JACKS

3-CONDUCTOR SUB-MINIATURE JACKS

2.5 - 3極超小形単頭ジャック

No. M02-A04A0 (2.5 -3極)

3-CONDUCTOR SUB-MINIATURE JACK FOR P.C.B
STEREO

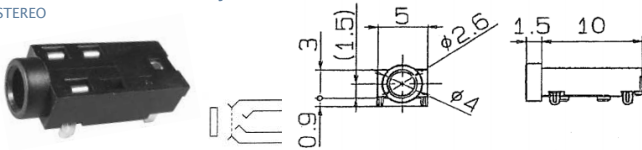

No. M02-909A0 (2.5 -3極) SMT

3-CONDUCTOR SUB-MINIATURE JACK FOR P.C.B
STEREO

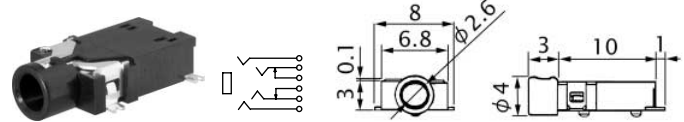

No. MJ-8925 (2.5 -3極) SMT

3-CONDUCTOR SUB-MINIATURE JACK FOR P.C.B
STEREO

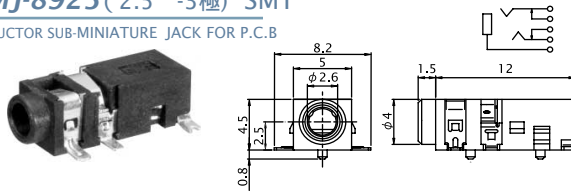

No. MJ-070N (2.5 -3極)

PANEL MOUNT SUB-MINIATURE JACK STEREO

No. MJ-070N0 (2.5 -3極)

SUB-MINIATURE JACK FOR P.C.B WITHOUT SCREW THREAD STEREO

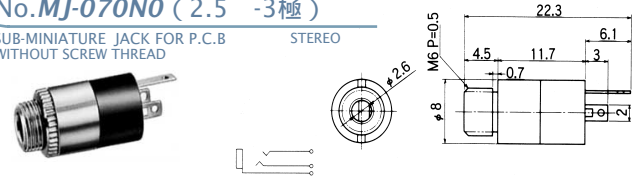

No. MJ-071H (2.5 -3極)

3-CONDUCTOR SUB-MINIATURE JACK
STEREO

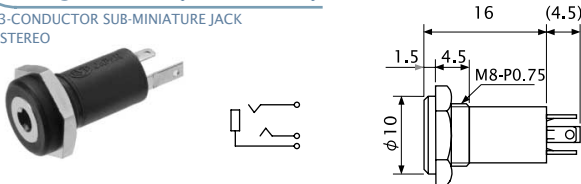

No. MJ-071SP (2.5 -3極)

SNAP-IN MOUNT SUB-MINIATURE JACK
STEREO

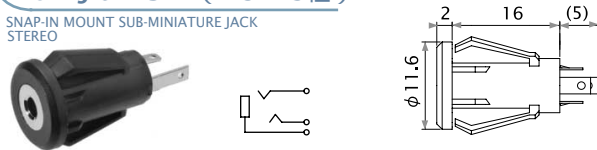

Marushin electric mfg. co., ltd



AUDIO PHONE PLUGS & JACKS

4-CONDUCTOR SUB-MINIATURE PLUGS & JACKS

2.5 - 4極超小形単頭プラグ・ジャック

No.MP-425 (2.5 -4極)

SUB-MINIATURE PLUG
4-CONDUCTOR

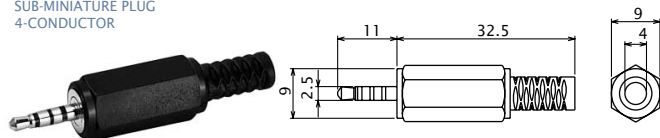

No.MP-425LN (2.5 -4極)

SUB-MINIATURE RIGHT ANGLE PLUG
4-CONDUCTOR

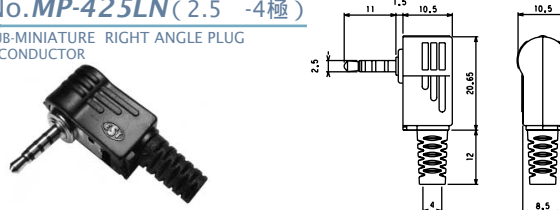

No.MC-4250 (2.5 -4極)

SUB-MINIATURE PLUG WITH 1.8M LONG CABLE
4-CONDUCTOR



No.MJ-0254S (2.5 -4極)

SUB-MINIATURE INLINE JACK
4-CONDUCTOR

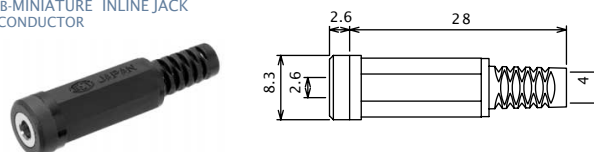

No.MC-4250L (2.5 -4極)

SUB-MINIATURE RIGHT ANGLE PLUG WITH 1.8M LONG CABLE
4-CONDUCTOR



No.MJ-068 (2.5 -4極)

SUB-MINIATURE INLINE JACK
4-CONDUCTOR

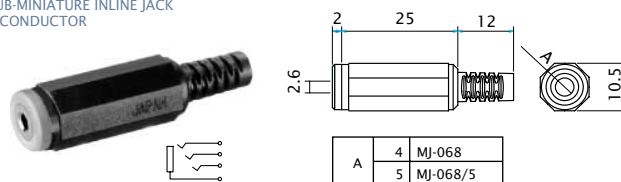

No.MJ-068SP (2.5 -4極)

SNAP-IN MOUNT SUB-MINIATURE JACK
4-CONDUCTOR

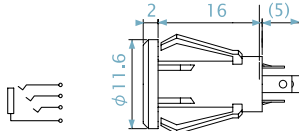

取付穴参考寸法
Mounting hole dimension

8



取付板板厚
Thickness of mounting board
t=1.0-1.8

No.MJ-069 (2.5 -4極)

PANEL MOUNT SUB-MINIATURE JACK
4-CONDUCTOR

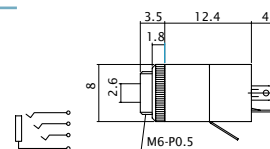

No.MJ-068H (2.5 -4極)

PANEL MOUNT SUB-MINIATURE JACK
4-CONDUCTOR

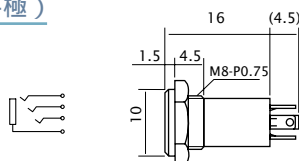

No.MC-254 (2.5 -4極)

SUB-MINIATURE PLUG WITH 1.8M LONG CABLE
4-CONDUCTOR

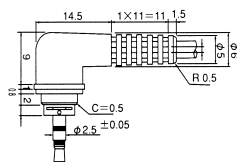

No.M19-442A (2.5 -4極)

SUB-MINIATURE PLUG FOR MOLDING
4-CONDUCTOR

